

Table of Contents	Page
2020 Annual Security Report	
About the Annual Security Report	1
The NMU Police Department Services	3
Reporting Crime and Other Emergencies	5
Confidential Reporting Procedures	6
Campus Security Authorities	7
Right of Written Notice	7
Emergency Response and Evacuation	8
Prevention and Education Programs	11
Crime Prevention Education and Awareness	11
Relationship Violence, Sexual Misconduct, and Stalking Policy	19
Alcohol and Drug Policies	20
Drug and Alcohol Abuse Education and Awareness	22
Access to Campus Facilities and Residence Halls	24
Daily Crime Log	25
Sex Offender Registration	25
Missing Student Policy	26
Crime Definitions	27
Crime Statistics	31
2019 Annual Fire Safety Report	
Fire Safety Systems	41
Fire Drills	42
Evacuation Procedures	42
Fire Safety Education and Training	46
Contact Information	46
Plans for Future Improvements	46

About the Annual Security Report

The Jeanne Clery disclosure of Campus Security Policy and Campus Crime Statistics Act, commonly referred to as “The Clery Act”, is a federal statute codified at 20 U.S.C. § 1092(f) that requires all public colleges and universities to:

- Publish an annual report each year by October 1st that contains three years of campus crime statistics and required campus security policy statements.
- Disclose crime statistics for the campus, public areas immediately adjacent to or roads running through the campus, and certain non-campus facilities.
- Provide “timely warning” notices of those crimes that have occurred and pose an ongoing threat to students, employees and guests of the University.
- Provide a means to notify the campus community (NMU ALERT) of an imminent or ongoing threat to safety, security or health.
- Disclose a public crime log for crimes that have occurred on campus or within the patrol jurisdiction of university police.
- Distribute the report. NMU’s Police Department is responsible for preparing and distributing the report. The NMU Police Department works with many other departments and agencies in obtaining the required statistics to complete the report.
- Make the report available. The report is available at www.nmu.edu/2019 Clery and at www.nmu.edu/policies and as a paper copy from the NMU Police Department. A paper copy can be obtained from the NMU Police Department at no charge.
- Complete other publicly available record-keeping while maintaining the confidentiality of any victim as allowed under regulation.

All policies referenced in the 2019 Annual Security Report and Fire Safety Report are linked in the Table of Contents above. They are also available directly at www.nmu.edu/policies. A copy of each policy referenced in this report is printed as of September 30, 2019 and retained in the NMU Police Department. Printed copies are available upon request at no charge.



NORTHERN MICHIGAN
UNIVERSITY

PUBLIC SAFETY AND
POLICE SERVICES OFFICE
227-2151



JACOBETTI COMPLEX
LOCATED JUST PAST
PUBLIC SAFETY OFFICE
(BUILDING NOT TO SCALE)



Lake
Superior

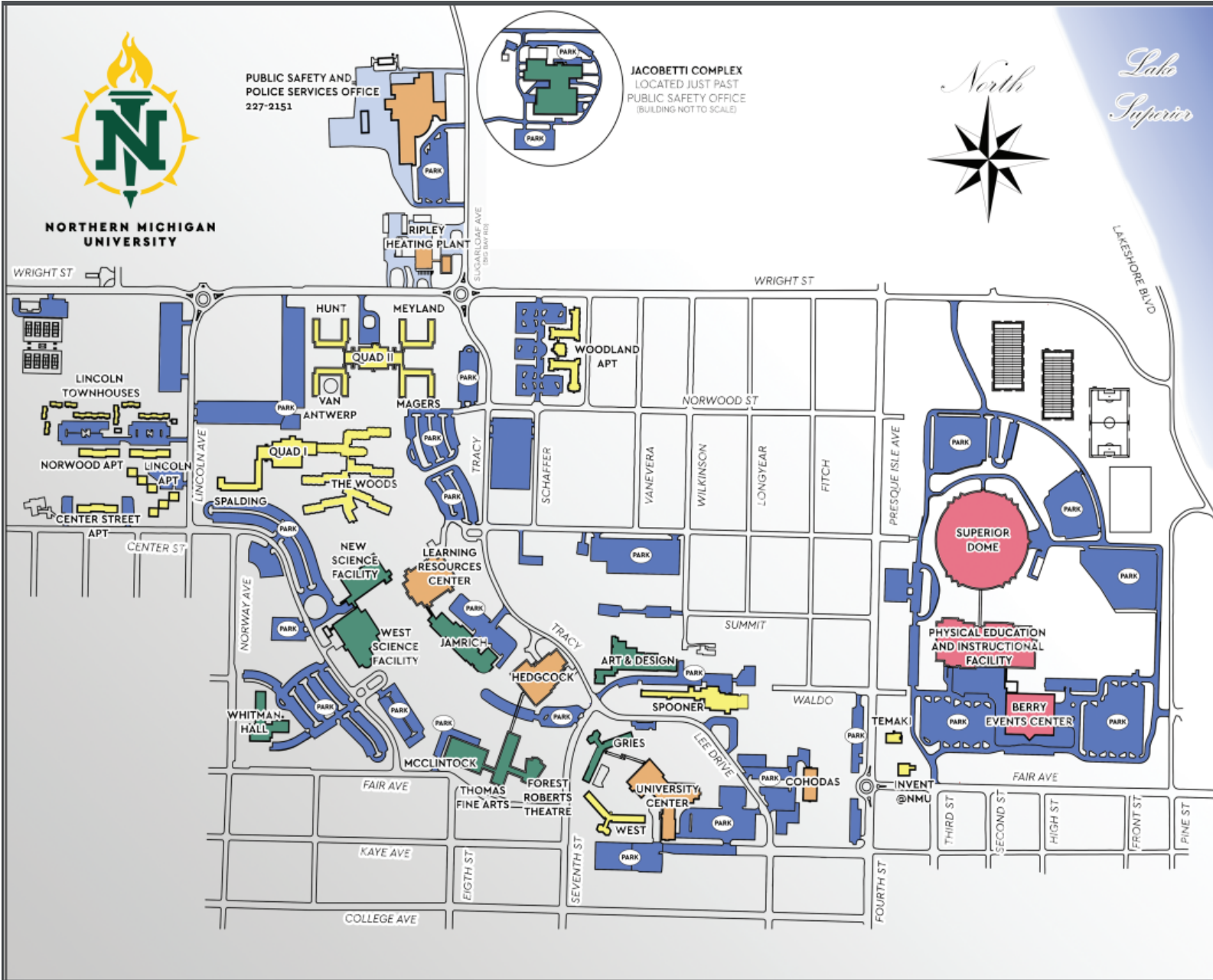

NMU Police Department

This section describes Northern Michigan University's Police Department, its authority to arrest individuals, and its relationship with other police agencies.

The NMU Police Department is staffed 24 hours a day, seven days a week, 12 months a year. The staff members include highly trained and dedicated law enforcement officers. These officers are responsible for the overall safety of the University community.

The NMU Police Department is located on Sugarloaf Drive (Services Building, Room 102). Non-Emergency: 906-227-2151 Emergency: 911

History, Training, and Interagency Cooperation

The officers at NMU have the same power and authority as other peace and police officers in the State of Michigan. This power was granted by NMU's Board of Trustees under Public Act 120. In addition, the officers are sworn Deputy Sheriffs for Marquette County.

NMU police officers must have earned a bachelor degree and are required to attend a regional police academy governed by the Michigan Commission on Law Enforcement Standards.

Officers are required to attend mandatory in-service training throughout the year to enable them to perform efficiently and safely. Northern Michigan University's Police Department works closely with several agencies, including Marquette City, Marquette County Sheriff's Department, Chocolay Township and the Michigan State Police. The NMU Police Department relies on relationships for support on several levels. In addition to sharing critical information, the NMU Police Department has immediate contact with the Regional Dispatch 911 Center. This arrangement provides immediate access to mutual aid and support from area agencies.

While there are no formal Memorandums of Understanding with Marquette City Police, Marquette County Sheriff's Department, Chocolay Township or the Michigan State Police regarding the investigation of criminal incidents, The NMU Police Department currently has a formal mutual aid agreement in place with the Marquette County Law Enforcement Agencies.

Our Mission and Values

The NMU Police Department will assist in providing a safe and secure living and learning environment for the University community consistent with the values and mission of the University. The organization is comprised of people of integrity, committed to providing quality service to the University community in an honest, fair, professional and courteous manner.

A partnership will be pursued with the University community based on mutual trust, confidence, commitment and communication to maintain and improve the quality of life and promote the safety and welfare of our campus.

The members of this agency pledge collectively and individually to constantly grow, develop and engage in reassessment to meet the current and future problems and challenges of our University community.

The values of Northern Michigan University's Police Department embody the department's philosophy, vision and values. These values serve as a foundation and catalyst upon which the department establishes its policies, strategy, tactics, and its actions. In completing its mission to protect and serve the University community of Northern Michigan University, the department as a whole and each of its members as individuals are responsible for adhering to all the principles and values that make up the law enforcement code of ethics.

The University coordinates with local police agencies to identify, monitor and record criminal activity involving students at off-campus locations.

The NMU Police Department monitors off-campus criminal activity that may affect the University community so that it may provide timely warnings and advisories. Although the department does not routinely record statistics on crimes that occur outside its legal jurisdictions, it does collect and publish statistics for select crimes occurring on public property within or immediately adjacent and accessible to the University. In general, prospective students, employees, and visitors to NMU should know that as with any campus, there is crime both on- and off-campus, and that it is important to take reasonable precautions at all times.

The NMU Police Department will actively investigate any information it receives concerning criminal activity, suspicious situations, or involves a member of the campus community. If the University is notified of a situation in which a campus community member is the victim of a crime, the department may issue a Timely Warning or Alert, detailing the incident and providing tips so that other community members may avoid similar incidents.

Reporting Crime and Other Emergencies

This section describes the general process for reporting a crime and the actions triggered by the report of a crime.

Northern Michigan University encourages the prompt and accurate reporting of all crimes. NMU Police Department is committed to responding to reports of criminal activities or other emergencies occurring on campus or affecting campus life. Accordingly, NMU has developed policies and procedures (reference [Emergency Response Policy](#) and [Relationship Violence, Sexual Misconduct, and Stalking Policy](#)) to ensure that:

- Timely warning is issued when certain types of crimes occur
- Campus is aware of the process to report crime
- Campus is aware of the responsibilities of Campus Security Authorities
- Campus is aware of the process for the confidential reporting of crime

Direct Report to the NMU Police Department

Call 911 to directly report criminal incidents, accidents, and other emergencies to the Marquette County Central Dispatch. Non-emergencies can be reported to (906) 227-2151. Individuals may also report incidents in person at the department headquarters located at the Sugar Loaf Avenue Services Building, room 100.

Dispatchers are available 24 hours a day to answer calls. In response to a call, the NMU Police Department will dispatch an officer to take the incident report. All criminal reports filed are forwarded to the Prosecutor's office and the NMU Dean of Students office for review and potential action. The NMU Police Department will investigate a report when deemed appropriate. Additional information obtained via the investigation will also be forwarded to the Dean of Students Office.

All individuals have the right to report crime to any appropriate law enforcement authority including on-campus and local police. NMU Police Department personnel will assist any student in notifying these authorities if a student requests assistance.

Reporting all crimes to the NMU Police Department ensures that the department receives the necessary information to assess the crimes for a potential Timely Warning if there is an ongoing or serious threat to the University community and for annual statistical reporting. The Emergency Response Policy and plans (detailed later in this report) include the use of the Timely Warning Notice and NMU Emergency Alert system.

Blue Light Emergency Phones

NMU began a proactive program with the installation of "Code Blue" emergency telephones that provide two-way communications from the phone site direct to the NMU Police Department allowing immediate response by patrols. The phones are located strategically throughout campus at different locations. The NMU Police Department officers physically inspect the emergency phones each week and report any malfunctions to telephone services for repair. A map of the Blue Light Phones is available at <https://www.nmu.edu/campusmap>.

Confidential Reporting Procedures

The victim of a crime who does not want to pursue action within the University system or the criminal justice system may still want to consider making a confidential report. Any campus security authority can file a report with the NMU Police Department on the details of the incident without revealing the identity of the victim. The purpose of a confidential report is to comply with the request to keep the matter confidential while taking steps to ensure the future safety of the victim and the University community. With this information, the University can keep an accurate record of the number of incidents involving students, determine where there is a pattern of crime with regard to a particular location, method, or assailant, and alert the University community to potential danger. Reports filed in this manner are counted and disclosed in the annual crime statistics for the institution.

Title IX requires that all reported incidents of sexual assaults must be investigated by the University and the University must take all necessary steps to remedy the situation.

Even if victims do not want the complaint pursued through the student conduct program or the courts, the University must still investigate and respond to comply with Title IX. If the victim/survivor requests confidentiality or asks that the complaint not be pursued, the Title IX coordinator will take all reasonable steps to investigate and respond to the complaint consistent with this request.

Confidential Reporting Procedures Specific to Counselors

As a result of the negotiated rulemaking process that followed the signing into law, the 1998 amendments to 20 U.S.C. Section 1092 (f), clarification was given to define those considered to be campus security authorities. Campus “Pastoral Counselors” and Campus “Professional Counselors,” when acting as such, are not considered to be a campus security authority and are not required to report crimes for inclusion into the annual disclosure of crime statistics. However, NMU policy (ref. [Relationship Violence, Sexual Misconduct, and Stalking Policy](#)) encourages Counselors to inform persons being counseled of the procedures to report crimes on a voluntary basis for inclusion into the annual crime statistics.

Counselors are defined as:

- Pastoral Counselor: An employee of an institution who is associated with a religious order or denomination and recognized by that religious order or denomination as someone who provides confidential counseling, and who is functioning within the scope of that recognition as a pastoral counselor.
- Professional Counselor: An employee of an institution whose official responsibilities include providing psychological counseling to members of the institution’s community and who is functioning within the scope of his or her employee’s license or certification.

Campus Security Authorities

Campus Security Authority is a Clery Act-specific term that describes the campus personnel who have specific responsibilities to take action when receiving notice of a crime. This section identifies who is a Campus Security Authority and what action must be taken when information about a crime is received.

Campus Security Authorities include four groups of individuals and organizations associated with an institution:

- Any individual or individuals who have responsibility for campus security but who do not constitute a campus or a campus security department (e.g. an individual who is responsible for monitoring the entrance into institutional property).
- Individuals who provide security at a campus parking kiosk, monitor access into a campus facility, and act as event security or escort students around campus after dark.
- Any individual or organization specified in an institution's statement of campus security policy as an individual or organization to which students and employees should report criminal offenses.
- An official of an institution who has significant responsibility for student and campus activities, including, but not limited to, student housing, student discipline and campus judicial proceedings. An official is defined as any person who has the authority and the duty to take action or respond to particular issues on behalf of the institution.

Campus Security Authorities (CSA) Responsibilities

Campus Security Authorities (CSA) are required to report any good-faith allegation of a Clery Act crime to the NMU Police Department. A Campus Security Authority is not responsible for determining authoritatively whether a crime took place; that is the function of law enforcement personnel. A campus security authority should not try to apprehend the alleged perpetrator of the crime; that too is the responsibility of law enforcement. It is also not a CSA's responsibility to try to convince a victim to contact law enforcement if the victim chooses not to do so. A current listing of identified Campus Security Authorities can be found on the Northern Michigan University [Clery page](#).

Right of Written Notice

The University's [Relationship Violence, Sexual Misconduct, and Stalking Policy](#) requires that each person reporting dating violence, domestic violence, sexual assault, or stalking will receive a written notification of the services that are available both on-campus and off-campus in the local community. These services are specifically listed in the [Relationship Violence, Sexual Misconduct, and Stalking Policy](#). Each person reporting will also be provided written notice of the interim measures that are available, including the availability of changes to academic, living, transportation, and working situations, regardless of whether the report is made to law enforcement or a campus security authority. For certain types of crime, including reports of sexual misconduct, both the complainant and the accused will receive written notice of the final disposition of the investigation.



Emergency Response and Evacuation Procedures

This section details the procedure that NMU uses to immediately notify the campus community upon the confirmation of a significant emergency or dangerous situation involving an immediate threat to the health or safety of students, employees or visitors on campus. Specifically, NMU will use the Timely Warning Notice Procedures to determine when an emergency or dangerous situation is present and the NMU Emergency ALERT system to notify campus. NMU will, without delay, and taking into account the safety of the community, determine the content of the notification and initiate the notification system, unless issuing the notification will, in the professional judgment of the Chief of Police or Deputy Chief of Police of the NMU Police Department, compromise efforts to assist a victim or to contain, respond to or otherwise mitigate the emergency.

Timely Warning Notice Procedures

The NMU Police Department, in conjunction with other departments on campus, issues warnings to notify community members about certain crimes in and around our community. Members of the community who know of a crime or other serious incident should report that as soon as possible to the NMU Police Department so that a warning can be issued if warranted.

Timely Warning Notices are issued whenever a crime or series of crimes on campus, or in some instances the surrounding communities, is considered to pose a serious or possible on-going threat to the university community. Timely Warnings are typically issued for Type I crimes and those considered Clery Act reportable. For example, a timely warning would be issued for the following crime classifications: major incidents of arson, criminal homicide, motor vehicle thefts, and robbery. Incidents of aggravated assault and sex offenses are considered on a case-

by-case basis, depending on the facts of the case and information once reported to the NMU Police Department. Warnings may also be posted for other crime classifications, as deemed necessary. The NMU Police Department reviews information that is reported to the campus police by members of the community, by campus security authorities, and by the local police to determine if a reported crime poses a serious or on-going threat to members of the university community. The NMU Police Chief or Deputy Chief reviews all reports to determine if there is the possibility of an ongoing threat to the community and if the distribution of a Timely Warning Notice is warranted. Updates to the campus community about any particular case resulting in a Timely Warning Notice may be distributed via mass email or text alert.

NMU Emergency ALERT

NMU Emergency ALERT is a means to notify the campus community of an imminent or ongoing threat to safety, security, or health (all hazards) of students or employees on campus. Upon confirmation by the Chief or Deputy Chief of the NMU Police Department that an emergency or dangerous situation is present, an alert notification the alert system will be disseminated without any delay with the goal of notifying as many people as possible, as rapidly as possible, taking into account the safety of the campus community. The alert content will be determined by the Chief or Deputy Chief of the NMU Police Department and will include a description of the emergency and recommended action. Alerts may be issued for, but are not limited to, active shooter, tornado, and dangerous chemical release.

Dissemination of Alerts may include any or all of the following:

- ☐ Mass Email
- ☐ Text Message Alert
- ☐ Web- www.nmu.edu
- ☐ Local Media
- ☐ Closed-Circuit Monitors
- ☐ Computer Override

The University community should be prepared to take self-protection measures appropriate to the emergency, such as, but not limited to, shelter- in-place or evacuation, depending upon the circumstances or incident.



Emergency Evacuation Procedures

The Northern Michigan University Police Department tests the emergency response and evacuation procedures on at least an annual basis. Generally, tests are not announced. New students are informed of NMU's emergency response and evacuation procedures at orientation, as well as in required residence hall meetings. All tests are documented by the NMU Police Department, including the time, date, and location of the test, and whether it was announced or unannounced.

Evacuation drills are coordinated by the NMU Police Department and the NMU Office of Housing and Residence Life. The frequency is determined by Michigan law. Students learn the

location of the emergency exits in residence buildings and receive guidance about the direction they should travel when exiting each facility for a short-term building evacuation and guidance about where they should assemble. The NMU Police Department does not tell residents in advance about the designated locations for evacuations because those decisions are affected by time of day, location of the building being evacuated, the availability of the various designated emergency gathering locations on campus, and other factors such as the location and nature of the emergency.

The purpose of these evacuation drills is to prepare building occupants for an organized evacuation in case of a fire or other emergency. At NMU, evacuation drills are used as a way to educate and train occupants on fire-safety issues specific to their building. During the drill, occupants “practice” drill procedures and familiarize themselves with the location of exits and the sound of the fire alarm. The process also provides the University an opportunity to test the operation of the fire alarm system components.

Evacuation drills are monitored by the NMU Police Department and the University’s housing staff to evaluate egress and behavioral patterns. Reports are prepared by participating departments that identify deficient equipment so that repairs can be made immediately. Recommendations for improvements also are submitted to the appropriate departments/offices for consideration of its emergency response and evacuation procedures.

For all buildings, including residence halls, evacuation routes and procedures are posted. These include:

1. When a fire alarm sounds, all personnel must evacuate the building immediately.
2. When evacuating, personnel must move away from the exit doors.
3. With the exception of fire department personnel and the NMU Police Department officers, no one is allowed to re-enter the building until notification has been given by a representative of the NMU Police Department.
4. If the fire alarm is silenced, this is not an indicator that it is safe to re-enter the building.
5. The NMU Police Department has the responsibility to determine that the building has been evacuated and when it is safe to re-enter. The officers will coordinate with maintenance, custodial and fire department personnel, as required.

Shelter-in-place

If an incident occurs and the building or areas become unstable, or if the air outdoors becomes dangerous due to toxic or irritating substances, it is usually safer to stay indoors. Thus, to “shelter-in-place” means to make a shelter of the building one is in. In a longer-term emergency, this location can be made even safer and more comfortable with a few adjustments until it is safe to go outside.

If an incident occurs and the building is not damaged, stay in an interior room until told it is safe to exit. If a building is damaged, take any personal belongings (purse, wallet, Wildcat Express Card, ID, etc.) and follow the evacuation procedures for the building (close the door, proceed to the nearest exit and use the stairs instead of the elevators). After evacuation, quickly seek

shelter at the nearest University building. If police or fire department personnel are on the scene, follow their directions.

A shelter-in-place notification may come from several sources, including the NMU Police Department, housing staff members and other University employees utilizing the University's emergency communications tools.

The basic steps of "shelter-in-place" will generally remain the same. Should the need ever arise; follow these steps (unless instructed otherwise by local emergency personnel):

- Stay inside. Collect any emergency shelter-in-place supplies and a telephone to be used in case of emergency. If outdoors, proceed into the closest building quickly or follow instructions from emergency personnel on the scene; locate a room to shelter inside. Ideally, the room will be an interior room at ground level without windows or with few windows. Large groups of people may need to use several rooms;
- Close and lock all windows and close exterior doors. Turn off air conditioners, heaters and fans. Close vents to ventilation systems you are able to. (University staff will turn off the ventilation as quickly as possible);
- Make a list of the people with you and ask someone to call and provide the list to the NMU Police Department so officers know where you are sheltering. If only students are present, one of the students should call and provide the list.
- Turn on a computer, radio, or TV and listen for further instructions;
- Make yourself comfortable.

Prevention and Education Programs

This section provides information about the type and frequency of programs designed to inform students and employees about campus security, crime prevention including sexual assault prevention, and alcohol and other drug abuse prevention. Northern Michigan University has a comprehensive [Relationship Violence, Sexual Misconduct, and Stalking Policy](#) that includes an overview of sexual misconduct, prevention programs and the procedure to follow if a sex offense occurs. The full policy is included in the appendix to this security report.

Crime Prevention Education and Awareness Programming Overview

Northern Michigan University places a high priority on maintaining a safe and secure campus for all students, faculty, staff, and visitors. Members of the University community learn about campus security procedures and crime prevention through programs presented across the University.

The NMU Police Department's crime prevention programming uses a layered approach including patrolling campus, crime prevention education and training, educating the community, and conducting building and area security surveys. This approach reduces criminal opportunities and encourages community members to take responsibility for their own and others' safety.

New employees and students first learn basic prevention and awareness information during their respective orientations. Returning students review bystander intervention through an annual online sexual misconduct awareness module. In addition to this mandatory training, ongoing programming addresses sexual violence, domestic violence, and drug and alcohol awareness education.

In addition, the NMU Police Department's personnel provides training to students, faculty, staff and guests on personal safety, drug, and alcohol safety, workplace violence, home and building security and new student orientation programs. The office is responsible for the Victim/Witness Advocacy Services and liaisons with University services, surrounding community services offices and representatives of the criminal justice system.

The NMU Police Department conducts frequent security surveys of campus buildings and facilities and prepares reports of any deficiencies for the responsible departments and the University Facilities Department. The office also maintains a daily police log of crimes reported. The daily crime and fire log is available online at the NMU Police Department's website. A printed daily log is also maintained in the department and is available for public review at the University dispatch office during business hours.

Safety and education programming is initiated by several groups across campus. Other than the NMU Police Department, those offering regular programming include the Health Promotion Office, Housing and Residence Life, the Dean of Students Office, and the Office of the President.

The Student's Responsibility

The cooperation and involvement of the students in a campus safety program is absolutely necessary. Students must assume responsibility for their own personal safety and the security of their personal belongings by taking simple, common sense precautions. Any student – male or female – may feel more comfortable using the Safe Walk Service when walking on campus late at night.

Valuable items such as stereos, cameras, and televisions should be marked with engraving instruments provided by the University Police at no charge. Bicycles should be registered with the University Police and be secured with a sturdy lock. Bicycle registration is free and can be done online in a matter of minutes.

Students with vehicles must park in the assigned areas. Unoccupied vehicles should be kept locked at all times. Valuables should be locked in the trunk. Students should report any suspicious-looking individuals whom they feel do not belong in their residence halls or any unusual incidents in and around residence halls to Residence Life staff or the University Police. The same holds true for classroom settings and other areas of campus.

Weapons

Weapons on Campus are Prohibited.

"Weapon" shall mean and include any rifle, shotgun, handgun, or other lethal or dangerous device which is capable of casting a projectile by explosion, air, gas, bow, crossbow, or

mechanical means, irrespective of whether such rifle, shotgun, handgun, or other device is loaded or otherwise ready for use. For a complete definition refer to [Ordinance 22.00 Weapons and Explosives Ordinance](#).

Crime Reduction Tips

Residential Safety:

- Lock your room or apartment whenever you leave and when you are sleeping.
- Do not prop card reader doors.
- Call 227-2151 if you see someone in the building who does not belong.
- Do not allow strangers to follow you into the building.

Workplace Safety:

- Keep personal items (purses, book bags) locked up.
- Secure the work area when no one is in it.
- Report suspicious people in the workplace area to the police.

Protecting Your Property:

- Record the serial numbers of your valuables.
- Engrave valuables with a unique identifying number or sequence of letters and numbers.
- Register your bike with the NMU Police Department.
- Consider installing anti-theft or alarm devices on your vehicle.
- Do not leave textbooks, purses, phones or book bags unattended.
- Do not leave laptop computers unattended.

How to be an Active Bystander

Bystanders play a critical role in the prevention of sexual and relationship violence. They are “individuals who observe violence or witness the conditions that perpetuate violence. They are not directly involved but have the choice to intervene, speak up, or do something about it.” Bystanders that are actively engaged in the prevention of violence help NMU report a culture of community accountability.

If you or someone else in immediate danger, call 906-227-2151 or 911. This could be when a person is yelling at or being physically abusive towards another and it is not safe for you to interrupt.

1. Watch out for your friends and fellow students/employees. If you see someone who looks like they could be in trouble or need help, ask if they are ok.
2. Confront people who seclude, hit on, and try to make out with, or have sex with people who are incapacitated.
3. Speak up when someone discusses plans to take sexual advantage of another person.
4. Believe someone who discloses sexual assault, abusive behavior, or experience with stalking.
5. Refer people to on or off campus resources listed in the document for support in health, counseling, or with legal assistance.

Risk Reduction

The following are some strategies to reduce one's risk of sexual assault or harassment:

- **Be Aware** of your surroundings. Knowing where you are and who is around you may help you to find a way to get out of a bad situation.
- Try to **avoid isolated areas**. It is more difficult to get help if no one is around.
- **Walk with purpose**. Even if you do not know where you are going, act like you do.
- **Trust your instincts**. If a situation or location feels unsafe or uncomfortable, go with your gut. If you see something suspicious, contact law enforcement immediately.
- **Try not to load yourself down** with packages or bags as this can make you appear more vulnerable.
- **Make sure your cell phone is with you** and charged and that you have cash money.
- **Do not allow yourself to be isolated** with someone you do not trust or someone you do not know.
- **Avoid putting music headphones in both ears** so that you can be more aware of your surroundings, especially if you are walking alone.
- **When you go to a social gathering, go with a group of friends**. Arrive together, stick in with each other throughout the evening, and leave together. Knowing where you are and who is around you may help you to find a way out of a bad situation.
- **Do not leave your drink unattended** while talking, dancing, using the restroom or making a phone call. If you have left your drink alone, just get a new one.
- **Do not accept drinks from people you do not know or trust**. If you choose to accept a drink, go with the person to the bar to order it, watch it being poured, and carry it yourself. At parties, do not drink from the punch bowl or other large, common open containers.
- **Watch out for your friends, and vice versa**. If a friend seems out of it, is way too intoxicated for the amount of alcohol they've had, or is acting out of character, get him or her to a safe place immediately.
- **If you suspect you or a friend has been drugged, contact law enforcement immediately (906-227-2151 on campus or 911)**. Be explicit with doctors so they can give you the correct tests (you will need a urine test and possibly others).

If you need out of an uncomfortable or scary situation, here are some things you can try:

- **Remember that being in this situation is not your fault**. You did not do anything wrong. It is the person who is making you uncomfortable that is to blame.
- **Be true to yourself**. Do not feel obligated to do anything you do not want to do. "I don't want to" is always a good enough reason. Do what feels right for you and what you are comfortable with.
- **Have a code word with your friends or family** so that if you do not feel comfortable you can call them and communicate your discomfort without the person you are with knowing. Your friends and family can then come to get you or make up an excuse for you to leave.
- **Lie**. If you do not want to hurt the person's feelings, it is better to lie and make up a reason to leave than to stay and be uncomfortable, scared, or worse. Some excuses you

could use are needing to take care of a friend or family member, not feeling well, having somewhere else you need to be, etc.

- **Try to think of an escape route.** How would you try to get out of the room? Where are the doors? Windows? Are there people around who might be able to help? Is there an emergency phone nearby?
- **If you and/or the other person have been drinking,** you can say that you would rather wait until you both have your full judgment before doing anything you may regret later.

Crime Prevention Education and Awareness Programming

Rape Aggression Defense is a program of realistic, self-defense tactics and techniques. The RAD System is a comprehensive course for women that begins with awareness, prevention, risk reduction and avoidance and progresses to the basics of hands-on defense training. RAD is taught by certified RAD Instructors and is dedicated to teaching women defensive concepts and techniques against various types of assault by utilizing easy, effective, and proven self-defense/martial arts tactics.

Operation Identification is a program that is a system for marking personal property. Students engrave their driver's license on the item and keep a permanent record of their property. Operation Identification has been proven to reduce thefts in communities where the program has been implemented.

General Orientation Program encourages both parents and students to be responsible for their own security and the security of others. The orientation packets include materials describing the resources available on campus to learn about crime prevention, as well as an introduction to the programs available for addressing risk on campus.

Specialized Orientation Programs include Army ROTC and athletics orientation. These orientation programs address sexual misconduct, sexual assault law in Michigan, bystander intervention, and the repercussion for misconduct at NMU.

Other programming may be offered less frequently than annually. The following is a list of programs, presentations and events for the 2019 calendar year.

Jan - Dec 2019 Programs		Attendance
1/02/2019	Triad Meeting	10
1/10/2019	New Student Orientation	200
1/15/2019	Women's Center RAD Program	5
1/29/2019	Cherry Creek Career Day	75
2/6/2019	Triad Meeting	15

2/12/2019	Wildcat Wellness Fair	200
2/15/2019	Westwood High School Career Day	75
2/16/2019	Ride Along	1
2/17/2019	Gwinn Health Fair	150
2/19/2019	Northern Center for Life Lifelong Learning	20
2/22/2019	Condominium	300
2/26/2019	Ride Along	1
2/27/2019	ASNMU RAD Program	32
3/1/2019	Ride Along	1
3/6/2019	Triad Meeting	15
3/18/2019	U.P. Reading Challenge	N/A
3/19/2019	Risk Management Seminar for Greek Life	5
3/20/2019	Interview with North Wind on Recreational Marijuana on Campus	N/A
3/23/2019	Hunt/VA Annual Root Beer Bash	230
3/26/2019	RAD Program	16
4/3/2019	Triad Meeting	20
4/6/2019	Ride Along	1
4/7/2019	Risk Management Seminar for Greek Life	15
4/7/2019	CRASE DARTS	10
4/9/2019	Ride Along	1
4/9/2019	Effects of Marijuana DARTS	15
4/15/2019	Teach Family HOMes Career Day	4
4/17/2019	RAD Program	4
4/22/2019	Triad Meeting. National Night Out Planning	10
4/25/2019	"Am I Evidence" Documentary. Q&A Panel	30
4/27/2019	Westwood Mall Children's Fair	175
4/27/2019	Ride Along	1

5/8/2019	Triad Meeting/National Night Out Planning	15
5/13/2019	NMU PD Video for UN100 - Posted Online	N/A
5/20/2019	Graffiti Coalition Informational	1
5/28/2019	Graffiti Coalition Meeting	10
5/31/2019	Orientation Staff Training	15
6/7/2019	Ride Along	1
6/11/2019	National Night Out Planning Meeting	5
6/12/2019	New Student Orientation	250
6/16/2019	Ride Along	1
6/19/2019	New Student Orientation	250
6/20/2019	Upward Bound - First Aid Presentation	5
6/26/2019	New Student Orientation	250
6/28/2019	Ride Along	1
6/28/2019	Walmart Children's Fair	25
7/3/2019	New Student Orientation	150
7/10/2019	New Student Orientation	250
7/13/2019	Ride Along	1
7/19/2019	CSI Youth Camp	7
7/27/2019	Ride Along	1
8/10/2019	Ride Along	2
8/13/2019	Ride Along	1
8/15/2019	Ride Along	1
8/16/2019	Athlete Orientation	100
8/20/2019	Athlete Orientation	50
8/20/2019	Athlete Orientation	75
8/21/2019	International Orientation	30
8/22/2019	New Student Orientation	250
8/22/2019	Transfer Student Orientation	10

8/22/2019	Assist Student Organization with Scavenger Hunt	N/A
8/22/2019	Wildcat Welcome Back Party	1000-2000
8/26/2019	Fall Fest	500
8/27/2019	Athlete Orientation	50
8/28/2019	Athlete Orientation	40
9/4/2019	Triad Meeting	10
9/4/2019	Alcohol/Sexual Assault Awareness with Club Sports	30
9/6/2019	Late Night at the BEC	505
9/9/2019	Bike Fair	100
9/10/2019	Torch Run	50
9/13/2019	Brookridge Heights Senior Citizen Prom	40
9/16/2019	Alcohol Awareness for Rugby	75
9/18/2019	RSVP Recognition Dinner	200
9/19/2019	Ride Along	1
9/23/2019	Risk Management Seminar for Greek Life	10
10/02/2019	Triad Meeting	15
10/03/2019	Van Antwerp Hall Full Sail Alcohol Awareness	20
10/07/2019	Presentation and Interviews for BC200 Journalism Class	20
10/08/2019	Risk Management Seminar for Greek Life	15
10/19/2019	Meyland Hall Full Sail Alcohol/Drug Awareness	23
10/23/2019	Interview with North Wind about Winter Driving	N/A
10/25/2019	Women for Women March	30
10/27/2019	Hunt/VA Full Sail Cold Weather Safety	15
10/29/2019	It's On Us Program	150
11/04/2019	Winter Driving Safety for USCG	20
11/04/2019	Met w/BSN Student to Assist w/ Preparing for Project	N/A
11/06/2019	Triad Meeting	10
11/10/2019	Risk Management Seminar for Greek Life	25

11/10/2019	OWI SAIL Program	30
12/02/2019	Drug/Alcohol Impairment SAIL Program	15
12/03/2019	Interview with the Northwind about Winter Safety	N/A
12/04/2019	Triad Meeting	15
12/07/2019	Shop with a Cop	N/A

Relationship Violence, Sexual Misconduct, and Stalking Policy

Northern Michigan University is committed to maintaining a safe learning and working environment – one free from dating violence, domestic violence, sexual assault, sexual harassment, sex discrimination, stalking, voyeurism, and any other behavior of a sexual nature that is non-consensual, collectively referred to as sexual misconduct. The University affirms the values of mutual respect, responsibility, and dignity for all members of the community. Sexual misconduct undermines NMU’s mission and violates the rights of our students, faculty, and staff. It is expressly prohibited. Retaliation against reporting sexual assault is also prohibited. Northern Michigan University’s [Relationship Violence, Sexual Misconduct, and Stalking Policy](#) is linked in this report and is available at www.nmu.edu/policies under Relationship Violence, Sexual Misconduct and Stalking. It includes:

- A description of the programs to address sexual assault, dating violence, domestic violence, and other non-consensual behavior of a sexual nature;
- The procedures students should follow if a sex offense occurs, including procedures concerning who should be contacted, the importance of preserving evidence for the proof of a criminal offense, and to whom the conduct should be reported;
- Information on a student’s option to notify appropriate law enforcement authorities, including on-campus and local police and information about how to obtain assistance in notifying these authorities;
- How to contact on-campus and off-campus counseling, mental health and other services for victims of sex offenses;
- How to obtain changes to academic or living situations after a reported sexual offense, called “interim measures;”
- Procedures for campus disciplinary action in cases of reported sex offense;
- Information about the reporter and respondent rights to have others present during a disciplinary proceeding and the right of both the reporter and respondent to be informed of the outcome of disciplinary proceedings; and
- The sanctions that NMU may impose following the final determination regarding sexual misconduct.

For more information please review the [Relationship Violence, Sexual Misconduct, and Stalking Policy](#).

Alcohol and Drug Policies – Drug-Free Schools and Communities Act Amendments of 1989

This section complies with the Drug-Free Schools and Communities Act Amendments of 1989. Northern Michigan University has adopted and implemented a program to prevent the unlawful possession, use or distribution of illicit drugs and alcohol by students and employees.

The program includes annual distribution in writing to each employee and to each enrolled student the following:

- Standards of conduct for students and employees
- A description of associated and legal sanctions
- A description of associated health risks
- A description of available services and treatment options

Alcohol and other drug issues have received much attention nationally and locally. Many students, faculty and staff have worked together over the years to prevent substance abuse at Northern Michigan University. We think our efforts have contributed to a healthy living-learning community and have assisted individuals in need.

Northern Michigan University is committed to preventing substance abuse by:

- Encouraging a campus environment where healthful lifestyle choices are made by students, faculty and staff.
- Expecting acceptance of responsibility for one's own choices and behavior.
- Striving to balance the rights of individuals and those of the university community.
- Encouraging chemical-free activities and supporting those who choose not to use alcohol and other drugs.
- Enforcing university, local and state codes, ordinances and statutes, which govern alcohol and other drug use.

Please see the [Drug-Free Schools Biennial Review](#) for more information.

The Northern Michigan University Student Handbook (<http://www.nmu.edu/handbook>) prohibits the use, possession, sale or consumption of alcoholic beverages by students in any building or on any property owned or controlled by NMU (except under terms and conditions established by the president or designee) and states that no student shall illegally possess, use or have under his/her control any other controlled substance in any building or on property owned or controlled by the University.

Failure to abide by these regulations may lead to any of the following sanctions: (1) warning, (2) warning probation, (3) disciplinary probation, (4) suspension or (5) expulsion. Special conditions may be attached to the penalty including, but not limited to, parental notification of the violation and mandatory participation in an alcohol or other drug education program.

Health Risks Associated with Alcohol and Other Drug Use

Regular use of alcohol and other drugs (including marijuana, stimulants, depressants, cocaine, anabolic steroids, opiates, hallucinogens) may lead to:

- psychological and/or physical dependence
- impaired learning ability, memory, ability to solve complex problems
- inability to perform sexually, infertility problems
- increased risk of sexually transmitted diseases (including AIDS)
- complications due to the combination of prescription medication and other drugs/alcohol
- death, coma or toxic reactions, especially when combining alcohol with any other drug, including over-the-counter medicine or prescriptions
- guilt/regret over activities performed while under the influence of alcohol/drugs, i.e., regretting sexual encounters, fighting, risk-taking, legal difficulties
- organic damage to brain, cardiovascular system, liver, etc.
- increased risk of cancer
- fetal Alcohol Syndrome, birth or genetic defects
- psychosis (hallucinations, loss of contact with reality, extreme changes in personality)
- other physiological, psychological or interpersonal problems

Substance Abuse Resources

On Campus

Dean of Students Office (University Center)	906-227-1700
Employee Assistance Service	906-227-2330
Counseling and Consultation Services (3405 Hedgcock)	906-227-2981

Marquette Area

UP Health System	906-449-3000
Alcohol/Narcotic/Opiate 24-hour help line	1-800-605-5043
Great Lakes Recovery Centers	906-228-7611
Outpatient services	906-228-6545
Youth residential	906-228-4692
Alcoholics Anonymous	1-800-605-5043

Alcoholic Beverages

Northern Michigan University seeks to encourage and sustain an academic environment that both respects individual freedom and promotes the health, safety and welfare of all members of its community. In keeping with these objectives, the University has established policy and guidelines governing the possession, use, sale and consumption of alcoholic beverages on the University campus that conform to the laws of Michigan. Underage possession and/or consumption of alcoholic beverages and public intoxication are not permitted. Northern Michigan University enforces Michigan underage drinking laws. Intentionally or knowingly selling, or intentionally or knowingly furnishing alcoholic beverages to persons under age 21, or to persons obviously inebriated, is not permitted. Legal consumption and possession of alcoholic beverages is limited to designated locations. The complete policy and guidelines

concerning alcoholic beverages is published in Northern Michigan University's policy and procedure database (www.nmu.edu/policies).

Illegal Drugs

The University does not condone the illegal possession, use, sale or distribution of marijuana, hallucinogens, narcotics or any other illegal drugs by anyone on campus property. Northern Michigan University enforces both Federal and Michigan drug laws. Any individual known to be possessing, using, or distributing such drug is subject to campus disciplinary action(s) and criminal arrest, imprisonment, and/or fine according to state and federal law.

Northern Michigan University complies with the **Drug-Free Schools and Communities Act** Amendments of 1989. Information regarding the Act can be found at www.nmu.edu/druginformationguide and outlines NMU's expectations and procedures for students, faculty and staff.

Drug and Alcohol Abuse Education and Awareness

Consistent with its educational mission, the University also assists its members in finding alternatives to alcoholic beverages by promoting social interaction and stress reduction, and it provides services and resources for community members who experience alcohol-related difficulties. Keeping informed is an important step in developing a healthy lifestyle and in knowing how to cope with problems as they arise.

Northern Michigan University provides useful and informative prevention education programs throughout the year in both residential and academic settings. The NMU Police Department conducts regular programming nearly 30 times a year. In addition, the NMU Health Promotion Office on campus provides education as well.

The University conducts the early intervention education program through the Dean of Students Office for students who violate the University's alcohol and other drug policies. The goal of the program is to help students reduce the risk of any type of alcohol or drug-related problems at any point of their lives. The program uses self-assessment to help students identify changes that can reduce the risk of alcohol or other drug related health problems.

Additional programs on a variety of health, wellness and social issues are offered by the Health Promotion Office. A variety of departments sponsor workshops and lectures on alcohol- and drug-related issues to support and encourage healthy, productive lifestyles. These programs are made available through:

NMU Police Department	(906) 227-2151
Student Counseling & Consultation Services	(906)-227-2980
Housing and Residence Life	(906)-227-2620
University Health Center	(906)-227-2355
Substance Abuse and Violence Education Support Services	(906)-227-1455

Alcohol and Drug Abuse Education and Awareness Programs

New Student Orientation Presentations - The Dean of Students and the NMU Police Department do a presentation as part of a Campus Health and Safety Presentation where students are introduced to a variety of talking points. Students are introduced to the fact that NOT all students drink and information is shared on the percentage that have reported not drinking in past surveys.

Late-night at the PEIF Event - This event has been held the Friday before classes start each fall semester for the last 14 years as part of the University's Welcome Weekend activities. This is an alcohol-free event that uses breathalyzers to ensure that each participant has not consumed any alcohol prior to entering. The event is intended to provide a safe place for students to enjoy a wide range of campus/off-campus recreational activities, be introduced to and try out the facilities and meet new friends in an alcohol-free environment. The event is promoted and partially funded by student groups including the ASNMU student government finance committee and the campus Greek community.

Residence Hall Director/Residence Assistant Training - This activity occurs once a year in the summer usually in late July or early August. The focus of this session is to be acquainted with the staff, introduce them to services on campus, and inform them how to reach out for consultations in situations involving alcohol, drugs, or crime.

Hospitality Program/Bar and Beverage Management Class – This once-a-year class invites the Health Promotion Office and the NMU Police Department to be part of an extensive educational process regarding the challenges of working with the consumer product alcohol. The students are provided insight into the impact of drinking and driving, the difficulty in determining the intoxication levels of their patrons and the outcomes of short- and long-term drinking on their patrons, their staff and families.

First Year Experience Tutorial (Required) for incoming students

Information is available online to incoming freshman students for sexual assault and addressing the role that alcohol can play when these crimes are being committed and safe bystander intervention. This includes an introduction to the University's [Medical Amnesty Policy](#).

Fitness and Well-Being Classes (HP200) – The Health Promotion Office provides educational support for the "Substance Abuse" chapter. Each class provides an overview to the Health Promotion Office, an introduction to the role that alcohol can play on campus, an interactive activity with a post-activity discussion and finally an introduction to campus and community resources.

Alcohol, AIDS, Acquaintance Rape Awareness Week

Generally scheduled for the last week in October, the Health Promotion Office plans and partners with other offices and student groups to provide campus-wide activities. The events are designed to raise awareness of and/or bring focus to health and safety topics related to alcohol and other drug risk, AIDS, and sexual violence.

Safe Holiday Campaign

In early December the NMU Police Department and the Health Promotion Office schedules events to raise awareness about the risk of impaired driving and other party related concerns.

Safer Break Week

Two weeks prior to spring break in late February, students are challenged to contemplate healthier and safer choices during their time away from campus.

Wildcat Wellness Fair

This fair provides opportunities for campus departments, student groups and community-based service providers to share a range of health and safety related booths, displays and activities including a variety of physical screenings.

Access to Campus Facilities and Residence Halls

Exterior door access for the University's residence halls and the Woodland Park apartments is controlled with an IP-based door access control technology tailored specifically for universities. This system allows Housing and Residence Life Office staff to manage exterior door access electronically.

Housing and Residence Life works diligently to provide a secure environment for residents while minimizing any inconveniences. Residents are encouraged to keep their room doors locked, keep exit doors secured, escort their guests at all times, and report any unusual circumstances to hall staff or the NMU Police Department immediately. Residents are held accountable for their guest's actions.

The NMU Police Department and the Residence Life staff are jointly responsible for the development of procedure and programs to promote the greatest possible safety and security of the residences halls. Educational programs emphasizing security and what residents can do to protect themselves are provided by Residence Life, University Police and other on- and off-campus services.

Most other campus facilities are open during weekday business hours. An automated card access system controls access after business hours. University members with questions about the system should contact the NMU Police Department at (906) 227-2151.

Daily Crime Log

The NMU Police Department maintains a Daily Crime Log. The Daily Crime Log is available for public inspection at the department's office located in room 102 of the Services Building or at www.nmu.edu/publicsafety/activity-log.

The Daily Crime Log includes the nature, date, time and general location of each crime reported to the department, as well as the disposition of the complaint, if this information is known at the time the log is created. The department posts specific incidents in the Daily Crime Log within two business days of receiving a report of an incident and reserves the right to exclude reports from the log in certain circumstances as allowed by law.

Safe Walk Service

The NMU Police Department provides escort services campus-wide during the hours of darkness. Student lot guards, when on duty, provide this service; otherwise, department patrol officers will make the transport when requested.

Security Surveys

Security surveys are conducted on a regular basis with members of the University community. The primary goal of these surveys is to identify areas of the physical campus that may present vulnerabilities to safety. The department works with the appropriate facilities office to address concerns noted in the surveys.

Concealed Weapons Permit

Campus visitors with a weapon and a CCW / Carry Concealed Weapon permit must register and store the weapon at the NMU Police Department.

Sex Offender Registration

The "Campus Sex Crimes Prevention Act" of 2000, which amends the Jacob Wetterling Crimes against Children and Sexually Violent Offender Registration Act, requires institutions of higher education to issue a statement advising the campus community where law enforcement information provided by a State concerning registered sex offenders may be obtained. It also requires sex offenders already required to register in a State to provide notice of each institution of higher education in that State at which the person is employed, carries a vocation, or is a student. In the State of Michigan, convicted sex offenders must register with the Sex Offender and Crimes against Minors Registry maintained by the State Police.

The Sex Offenders Registration Act, MCL 28.721et seq., directs the Michigan State Police to develop and maintain a public registry and provides guidelines on the type of offender information available to the public. The registration requirements of the Sex Offenders Registration Act are intended to provide the people of this state with an appropriate, comprehensive, and effective means to monitor those persons who pose such a potential danger.

Information concerning registered sex offenders may be viewed at:
www.michigan.gov/msp/0,4643,7-123-1878_24961---,00.html

Missing Person Policy

It is the policy of Northern Michigan University to actively investigate any report of a missing person(s) as defined below. There is no waiting period before the commencement of an investigation and procedures will be governed by federal, state and local laws. Report a missing person to the NMU Police Department.

A missing person is defined as a “person affiliated with the University being a student, faculty or staff member” or any other person last seen on the property of Northern Michigan University and reported as missing - or - a person affiliated with the University but not on campus at the time they were reported missing.

The housing application for each student living in on-campus housing includes the option to identify a contact person or persons whom NMU shall notify within 24 hours of the determination that a student is missing. The Dean of Students Office will determine when further contact will be initiated. However, if the student is under 18 years of age and not emancipated, the student's custodial parent or guardian will be notified immediately. In all cases the contact person will be notified within 24 hours. Regardless of whether a contact person has been identified, local law enforcement will be notified within 24 hours unless local law enforcement agency was the entity that made the determination that the student was missing.

For more information please see the [Missing Person Policy](#).

Sexual Misconduct Awareness

Northern Michigan University utilizes a range of training to promote awareness, risk reduction, and prevention programming in an effort to reduce the risk of sexual misconduct. **Sexual misconduct includes any of the following acts: sexual assault, sexual harassment, stalking, dating violence, voyeurism, sex discrimination, domestic violence, and any other conduct of a sexual nature that is non-consensual.**

For more information please see the [Relationship Violence, Sexual Misconduct, and Stalking Policy and Procedure](#).

Northern Michigan University provides online training to employees on preventing harassment, discrimination, and sexual violence, and how to report it through Law Room. Campus Clarity provides training to all incoming first-year students and transfer students on the same topics. Returning students are provided a modified version of the Campus Clarity module each year following their first year at Northern. Programs and other training offered throughout the year covers bystander intervention, prevention and risk reduction awareness, including training on institutional policies on sex/gender discrimination and sexual and/or relationship misconduct.

- **Murder and Non-Negligent Manslaughter** is defined as *the willful (non-negligent) killing of one human being by another.*
- **Manslaughter by Negligence** is defined as *the killing of another person through gross negligence.*
- **Sexual Assault - SAPAC Definition:** SAPAC defines sexual assault as any form of unwanted sexual contact obtained without consent and/or obtained through the use of force, threat of force, intimidation, or coercion.
- **Sexual Assault – State of Michigan Definition:** There are four degrees of Criminal Sexual Conduct (CSC) under Michigan law and they cover a range of sexual contact and levels of force or intimidation. Survivor resistance is not a factor in assessing CSC and the law is gender neutral. Marital rape has also been illegal in Michigan since 1988.

a) First Degree Criminal Sexual Conduct

1. Sexual Penetration (sexual intercourse, cunnilingus, fellatio, anal intercourse, any other intrusion of a body part or an object into genital or anal openings); and
2. One of the following circumstances:
 - a. Victim under 13
 - b. Victim 14, 15, or 16 and one of the following
 - i. member of the same household
 - ii. related by blood or affinity
 - iii. assailant in position of authority over victim
 - c. Occurs during commission of another felony
 - d. Assailant is aided by another person, and one of the following:
 - i. victim incapacity *(victim is mentally incapable, mentally incapacitated, and/or physically helpless – see definitions of these below)
 - ii. assailant uses force or coercion
 - e. Weapon involved
 - f. Force or coercion and personal injury (bodily injury, disfigurement, mental anguish, chronic pain, pregnancy, disease, or loss or impairment of a sexual or reproductive organ)
 - g. Personal injury and victim incapacity
 - h. Victim incapacity and one of the following:
 - i. related by blood or marriage
 - ii. assailant in position of authority over victim

Punishable by up to life imprisonment.

b) Second Degree Criminal Sexual Conduct

1. Sexual Conduct (intentional touching of intimate parts or clothing covering intimate parts, for the purpose of sexual arousal or gratification) and
2. Any of the circumstances listed for 1st degree CSC

Punishable by up to 15 years imprisonment.

c) Third Degree Criminal Sexual Conduct

1. Penetration (see definition under CSC 1) and
2. One of the following circumstances:
 - a. Victim 13, 14, or 15
 - b. Force or coercion
 - c. Victim incapacity

Punishable by up to 15 years imprisonment.

d) Fourth Degree Criminal Sexual Conduct

1. Sexual Contact (see definition under CSC 2), and
2. One of the following circumstances
 - a. Force or coercion
 - b. Victim incapacity
 - c. Assailant is employed by department of corrections in which victim is incarcerated

Punishable by up to 2 years imprisonment and/or fine of \$500.00

***Mentally Incapable** – a mental disease or defect makes the victim incapable of understanding the nature of his/her conduct.

***Mentally incapacitated** – victim is temporarily incapable of appraising or controlling his/her conduct due to the influence of a narcotic, anesthetic or other substance administered without consent or due to any other act committed upon the victim without consent.

Physically helpless – victim is unconscious, asleep, or for any other reason physically unable to communicate unwillingness to act.

- **Sexual Assault (Sex Offenses)** *Any sexual act directed against another person, without consent of the victim, including instances where the victim is incapable of giving consent.*
 - a) Rape** *is the penetration, no matter how slight, of the vagina or anus, with any body part or object, or oral penetration by a sex organ of another person, without the consent of the victim. This offense includes the rape of both males and females.*
 - b) Fondling** *is the touching of the private body parts of another person for the purpose of sexual gratification, without the consent of the victim, including instances where the victim is incapable of giving consent because of his/her age or because of his/her temporary or permanent mental incapacity.*
 - c) Incest** *is sexual intercourse between persons who are related to each other within the degrees wherein marriage is prohibited by law.*
 - d) Statutory Rape** *is sexual intercourse with a person who is under the statutory age of consent.*
- **Robbery** *is the taking or attempting to take anything of value from the care, custody, or control of a person or persons by force or threat of force or violence and/or by putting the victim in fear.*
- **Aggravated Assault** *is an unlawful attack by one person upon another for the purpose of inflicting severe or aggravated bodily injury. This type of assault usually is accompanied by the use of a weapon or by means likely to produce death or great bodily harm.*

- **Burglary** is the unlawful entry of a structure to commit a felony or a theft.
- **Motor Vehicle Theft** is the theft or attempted theft of a motor vehicle.
- **Arson** is any willful or malicious burning or attempt to burn, with or without intent to defraud, a dwelling house, public building, motor vehicle or aircraft, personal property of another, etc.
- **Hate Crimes** is a criminal offense that manifests evidence that the victim was intentionally selected because of the perpetrator's bias against the victim.
 - a) **Race** is a performed negative attitude towards a group of persons who possess common physical characteristics, e.g., color of skin, and/or hair; facial features, etc., genetically transmitted by descent and heredity which distinguish them as distinct division of humankind, e.g., Asians, blacks or African Americans, whites.
 - b) **Religion** is a performed negative opinion or attitude toward a group of persons who share the same religious beliefs regarding the origin and purpose of the universe and the existence or nonexistence of a supreme being, e.g., Catholics Jews, Protestants, atheists.
 - c) **Sexual Orientation** is a performed negative opinion or attitude toward a group of persons based on their actual or perceived sexual orientation.
 - d) **Gender** is a performed negative opinion or attitude toward a person or group of persons based on their actual or perceived gender, e.g., male or female.
 - e) **Gender Identity** is a performed negative opinion or attitude toward a person or group of persons based on their actual or perceived gender identity, e.g., bias against transgender or gender non-conforming individuals.
 - f) **Ethnicity** is a performed negative opinion or attitude toward a group of people whose members identify with each other, through a common heritage, often consisting of a common language, common culture (often including a shared religion) and/or ideology that stresses common ancestry.
 - g) **National Origin** is a performed negative opinion or attitude toward a group of people based on their actual or perceived country of birth.
 - h) **Disability** is a performed negative opinion or attitude toward a group of persons based on their physical or mental impairments, whether such disability is temporary or permanent, congenital or acquired by heredity, accident, injury, advanced age or illness.
- **Larceny-Theft** is the unlawful taking, carrying, leading or riding away of property from the possession or constructive possession of another.
- **Constructive possession** is the condition in which a person does not have physical custody or possession, but is in a position to exercise dominion or control over a thing.
- **Simple Assault** is an unlawful physical attack by one person upon another where neither the offender displays a weapon, nor the victim suffers obvious severe or aggravated bodily injury involving apparent broken bones, loss of teeth, possible internal injury, severe laceration, or loss of consciousness.
- **Intimidation** is to unlawfully place another person in reasonable fear of bodily harm through the use of threatening words and/or other conduct, but without displaying a weapon or subjecting the victim to actual physical attack.
- **Destruction/Damage/Vandalism of Property** is to willfully or maliciously destroy, damage, deface, or otherwise injure real or personal property without the consent of the owner or the person having custody or control of it.

- **Dating Violence** is defined as violence committed by a person who is or has been in a social relationship of a romantic or intimate nature with the victim. The existence of such a relationship shall be determined based on the reporting party's statement and with consideration of the length of the relationship, and the frequency of interaction between the persons involved in the relationship.
- **Domestic Violence** is defined as a felony or misdemeanor crime of violence committed-
 - By a current or former spouse or intimate partner of the victim;
 - By a person with whom the victim shares a child in common;
 - By a person who is cohabitating with, or has cohabitated with, the victim as a spouse or intimate partner;
 - By a person similarly situated to a spouse of the victim under the domestic or family violence laws of the jurisdiction in which the crime of violence occurred.
- **Stalking** is defined as engaging in a course of conduct directed at a specific person that would cause a reasonable person to
 - Fear for the person's safety or the safety of others; or
 - Suffer substantial emotional distress.
- **Course of Conduct** means two or more acts, including, but not limited to, acts in which the stalker directly, or through third parties, by any action, method, device, or means, follows, monitors, observes, surveils, threatens, or communicates to or about a person, or interferes with a person's property.
- **Reasonable person** means a reasonable person under similar circumstances and with similar identities to the victim.
- **Substantial emotional distress** means significant mental suffering or anguish that may, but does not necessarily require medical or other professional treatment or counseling.
- **Arrest for Clery Act purposes** is defined as persons processed by arrest, citation or summons.
- **Referred for disciplinary action** is defined as the referral of any person to any official who initiates a disciplinary action of which a record is established and which may result in the imposition of a sanction.
- **Weapons: Carrying, Possessing, Etc.,** is defined as the violation of laws or ordinances prohibiting the manufacture, sale, purchase, transportation, possession, concealment, or use of firearms, cutting instruments, explosives, incendiary devices or other deadly weapons. This classification encompasses weapons offenses that are regulatory in nature.
- **Drug Abuse Violations** are defined as the violation of laws prohibiting the production, distribution and/or use of certain controlled substances and the equipment or devices utilized in their preparation and/or use. The unlawful cultivation, manufacture, distribution, sale, purchase, use, possession, transportation or importation of any controlled drug or narcotic substance. Arrests for violations of state and local laws, specifically those relating to the unlawful possession, sale, use, growing, manufacturing and making of narcotic drugs.
- **Liquor Law Violations** are defined as the violation of state or local laws or ordinances prohibiting the manufacture, sale, purchase, transportation, possession or use of alcoholic beverages, not including driving under the influence and drunkenness.

Northern Michigan University Crime Statistics

The following chart contains the number of reported crimes on campus required by the Jeanne Clery Disclosure of Campus Security Policy and Campus Crime Statistics Act -Formerly known as the Crime Awareness and Campus Security Act of 1990. Recent amendments to the Clery Act require the University to specifically indicate whether reports involve dating violence, domestic violence, and/or stalking as well as any reports that include gender identity or national origin as a bias.

Criminal Offenses on Campus

Nature of Complaint	Reported 2017	Reported 2018	Reported 2019
Murder	0	0	0
Manslaughter	0	0	0
Rape	21	8	3
Fondling	0	0	1
Incest	0	0	0
Statutory Rape	0	0	0
Robbery	0	0	0
Aggravated Assault	0	0	2
Burglary	1	1	0
Motor Vehicle Theft	2	0	0
Arson	0	0	0

Criminal Offense on Campus Student Housing Facilities

Nature of Complaint	Reported 2017	Reported 2018	Reported 2019
Murder	0	0	0
Manslaughter	0	0	0
Rape	21	8	3
Fondling	0	0	0
Incest	0	0	0
Statutory Rape	0	0	0
Robbery	0	0	0
Aggravated Assault	0	0	1
Burglary	1	1	0
Motor Vehicle Theft	0	0	0
Arson	0	0	0

Criminal Offenses - Noncampus

Nature of Complaint	Reported 2017	Reported 2018	Reported 2019
Murder	0	0	0
Manslaughter	0	0	0
Rape	0	0	0
Fondling	0	0	0
Incest	0	0	0

Statutory Rape	0	0	0
Robbery	0	0	0
Aggravated Assault	0	0	0
Burglary	0	0	0
Motor Vehicle Theft	0	0	0
Arson	0	0	0

Criminal Offenses – Public Property

Nature of Complaint	Reported 2017	Reported 2018	Reported 2019
Murder	0	0	0
Manslaughter	0	0	0
Rape	0	0	0
Fondling	0	0	2
Incest	0	0	0
Statutory Rape	0	0	0
Robbery	0	0	0
Aggravated Assault	0	0	0
Burglary	0	0	0
Motor Vehicle Theft	0	0	0
Arson	0	0	0

Hate Crimes – On Campus

Nature of Complaint	Reported 2017	Reported 2018	Reported 2019
Murder	0	0	0
Rape	0	0	0
Fondling	0	0	0
Incest	0	0	0
Statutory Rape	0	0	0
Robbery	0	0	0
Aggravated Assault	0	0	0
Burglary	0	0	0
Motor Vehicle Theft	0	0	0
Arson	0	0	0
Simple Assault	0	0	0
Larceny Theft	0	0	0
Intimidation	1	0	0
Destruction/Damage/Vandalism of Property	0	0	0

Hate Crimes – On Campus Student Housing Facilities

Nature of Complaint	Reported 2017	Reported 2018	Reported 2019
Murder	0	0	0
Rape	0	0	0
Fondling	0	0	0
Incest	0	0	0
Statutory Rape	0	0	0
Robbery	0	0	0
Aggravated Assault	0	0	0
Burglary	0	0	0
Motor Vehicle Theft	0	0	0
Arson	0	0	0
Simple Assault	0	0	0
Larceny Theft	0	0	0
Intimidation	1	0	0
Destruction/Damage/Vandalism of Property	0	0	0

Hate Crimes – Noncampus

Nature of Complaint	Reported 2017	Reported 2018	Reported 2019
Murder	0	0	0
Rape	0	0	0
Fondling	0	0	0
Incest	0	0	0
Statutory Rape	0	0	0
Robbery	0	0	0
Aggravated Assault	0	0	0
Burglary	0	0	0
Motor Vehicle Theft	0	0	0
Arson	0	0	0
Simple Assault	0	0	0
Larceny Theft	0	0	0
Intimidation	0	0	0
Destruction/Damage/Vandalism of Property	0	0	0

Hate Crimes – Public Property

Nature of Complaint	Reported 2017	Reported 2018	Reported 2019
Murder	0	0	0
Rape	0	0	0
Fondling	0	0	0
Incest	0	0	0
Statutory Rape	0	0	0
Robbery	0	0	0
Aggravated Assault	0	0	0
Burglary	0	0	0
Motor Vehicle Theft	0	0	0
Arson	0	0	0
Simple Assault	0	0	0
Larceny Theft	0	0	0
Intimidation	0	0	0
Destruction/Damage/Vandalism of Property	0	0	0

VAWA Offenses – On Campus

Nature of Complaint	Reported 2017	Reported 2018	Reported 2019
Domestic Violence	5	4	2
Dating Violence	5	4	4
Stalking	2	1	2

VAWA Offenses – On Campus Student Housing Facilities

Nature of Complaint	Reported 2017	Reported 2018	Reported 2019
Domestic Violence	5	4	0
Dating Violence	5	4	3
Stalking	2	1	2

VAWA Offenses – Noncampus

Nature of Complaint	Reported 2017	Reported 2018	Reported 2019
Domestic Violence	0	0	0
Dating Violence	0	0	0
Stalking	0	0	0

VAWA Offenses – Public Property

Nature of Complaint	Reported 2017	Reported 2018	Reported 2019
Domestic Violence	0	0	0
Dating Violence	0	0	0
Stalking	0	0	0

Arrests – On Campus

Nature of Complaint	Reported 2017	Reported 2018	Reported 2019
Weapons Violations	0	1	0
Drug Violations	47	49	60
Liquor Violations	9	16	25

Arrests – On Campus Student Housing Facilities

Nature of Complaint	Reported 2017	Reported 2018	Reported 2019
Weapons Violations	0	1	0
Drug Violations	37	36	45
Liquor Violations	6	14	23

Arrests – Noncampus

Nature of Complaint	Reported 2017	Reported 2018	Reported 2019
Weapons Violations	0	0	0
Drug Violations	0	2	0
Liquor Violations	0	0	0

Arrests – Public Property

Nature of Complaint	Reported 2017	Reported 2018	Reported 2019
Weapons Violations	0	0	0
Drug Violations	1	0	1
Liquor Violations	3	0	1

Unfounded Crimes

If a reported crime is investigated by law enforcement authorities and found to be false or baseless, the crime is “unfounded”. Only sworn or commissioned law enforcement personnel may unfound a crime.

	Reported 2017	Reported 2018	Reported 2019
Total Unfounded Crimes	2	3	1

**Northern Michigan University
Higher Education Opportunity Act
2019 Fire Safety Annual Compliance Report**

Building Fire Safety Systems

University buildings are equipped with various safety systems. Fire Safety Systems include suppression and audible notification systems.

Description of Residence Hall Fire Safety Systems

Each residence hall room and common areas, except laundry rooms and mechanical rooms, are monitored with addressable photoelectric sensors (smoke detectors). Laundry rooms and mechanical rooms are monitored with addressable heat sensors. All detectors have been installed per appropriate codes and are networked using a dedicated copper backbone cable to a local annunciation panel located in each residence hall lobby. A residence hall room smoke detector that goes into alarm will also cause an alarm in the resident director's apartment, in the appropriate resident advisor's room and at The NMU Police Department. The fire detection system in each residence hall is networked using dedicated copper cable and/or fiber optic cable to the NMU Police Department office, where it is continuously monitored.

Residence hall rooms, bathrooms, and common areas are covered by a wet pipe fire suppression system. The attic spaces in the four recently renovated residence halls – Magers, Meyland, Van Antwerp, Hunt, and Woodland Park – are protected with a dry pipe system. The fire suppression system is monitored locally and centrally in the same manner as the fire/smoke detection system.

Fire Alarms

Every time any building fire alarm sounds, the building shall be immediately evacuated, regardless of what may have caused the alarm.

**Activated Fire Alarms,
Notification to the NMU Police Department**

For on-campus buildings (Stateside buildings, Recreational buildings, Auxiliary Services, Resident halls, and Woodland Apts.) whenever a fire alarm system is activated, a signal is received at the NMU Police Department Dispatch Center. The NMU Police Department Personnel are immediately dispatched to respond and quickly determine the cause of the alarm.

Residence Hall Fire Drills

Fire drills are conducted each semester in each residence hall. All rooms are searched to insure there is full evacuation. Anyone who does not promptly evacuate is referred to the Dean of Students for disciplinary action.

Number of Fire Drills Held - 2019

NMU follows Michigan's Bureau of Fire Services, Fire Division, Postsecondary Educational Institutions Instructional Staff Training, and Fire Drills & Reporting Requirements. Two fire drills were held in each of the residence halls, including, Hunt, Magers, Meyland, Spooner, Van Antwerp, West, Maple East, Maple West, Cedar East, Cedar West, Birch East, and Birch West during the academic year and one is conducted in any dormitory that is occupied in the summer academic period. Spalding Hall had one fire drill in the spring semester. This dormitory was taken offline after the spring semester.

Evacuation Procedures Residence hall students - A flier / building diagram is posted on the back of every residence hall room door that states:

FIRE ALARM INSTRUCTIONS

- Prepare to leave your room immediately, but feel your room door before opening it.
- If your room door is hot to the touch and you are above the 1st floor, stay in your room (you are safer there):
- Seal off cracks with towels or blankets (wet if possible) around the door to your room.
- Stay near your window and let emergency personnel know where you are by signaling from your window and/or call the NMU Police 911. Emergency personnel will let you know what to do and will provide you with assistance.
- If your room door is hot and you are on the 1st floor you can leave your room through your window if it is safe to do so.
- If your room door is cool, open your door cautiously. Be prepared to close it quickly if smoke or heat comes in:
- If the hall is clear, leave your room immediately, making sure your room door is closed and leave the building by the most direct route.
- If the most direct route is blocked by fire, intense smoke or emergency personnel, use another exit.
- If both routes are blocked, return to your room (see procedure above).
- Once you have left the building, stay out and stand away from the entrance until the alarm has been shut off and you are given permission to reenter.

FIRE IN ROOM

- If the fire is in your room, get out and close your room door.
- Pull the nearest fire alarm and leave the building.
- If you have access to a phone, call 911 to report the fire, your hall and room number.
- Once you have left the building, stay out and stand away from the entrance until the alarm has been shut off and you are given permission to reenter.

Student Housing Evacuation Procedures

The following flier with a building diagram is posted on the back of every residence hall room door:

FIRE ALARM INSTRUCTIONS

- Prepare to leave your room immediately, but feel your room door before opening it.
- If your room door is hot to the touch and you are above the 1st floor, stay in your room (you are safer there):
- Seal off cracks with towels or blankets (wet if possible) around the door to your room.
- Stay near your window and let emergency personnel know where you are by signaling from your window and/or call the NMU Police Department 911.
- Emergency personnel will let you know what to do and will provide you with assistance.
- If your room door is hot and you are on the 1st floor you can leave your room through your window if it is safe to do so.
- If your room door is cool, open your door cautiously. Be prepared to close it quickly if smoke or heat comes in:
- If the hall is clear, leave your room immediately, making sure your room door is closed and leave the building by the most direct route.
- If the most direct route is blocked by fire, intense smoke or emergency personnel, use another exit.
- If both routes are blocked, return to your room (see procedure above).
- Once you have left the building, stay out and stand away from the entrance until the alarm has been shut off and you are given permission to reenter.

FIRE IN ROOM

- If the fire is in your room, get out and close your room door.
- Pull the nearest fire alarm and leave the building.
- If you have access to a phone, call 911 to report the fire, your hall and room number.
- Once you have left the building, stay out and stand away from the

False Fire Alarms

Causing a false fire alarm is not only against University policy and an inconvenience to everyone in the building, it is also a crime. The University takes this very seriously, and will act swiftly and severely with anyone who causes a false fire alarm. Those found responsible for causing a false fire alarm are charged by the University with the criminal charge of FIRE-FALSE ALARM (750.240), are processed by the court system, and are referred to the Dean of Students for disciplinary action.

Tampering with Fire Safety Equipment

Tampering with any fire safety equipment, whether it is a pull station, smoke or heat detector, sprinkler head, horn/strobe unit or fire extinguisher, is a crime and against University policy.

Escaping a Fire

If there is a fire in the room, get out immediately and close the door. Once out, call 911. If there is a fire in the building, feel your door before opening it; if it feels hot, do not open it. Seal the cracks around it with sheets or clothes to prevent smoke from entering. If the outside air is clean, open the window and wave a sheet to attract rescuers. Use the phone to call The NMU Police Department. If the door is cool, open it, leave and close it behind you. Proceed to the nearest exit. If there is smoke in the hallway, stay low where the air is freshest. A wet cloth over your mouth and nose will also help with breathing. Never use elevators during a fire. Do not try to save possessions. Finally, know more than one way to leave the building.

Keep Stairwells and Hallways Clear

All corridors, stairwells and public areas must be kept free of obstructions. No furniture or personal belongings may be left in the hallways.

Fire Doors Must Remain Closed

Hallway, stairwell and residence room doors are fire doors and are there to protect you from smoke and flame. These doors are “fire rated” to provide such protection. However, they are of no value if they are propped open, allowing heat, smoke or flames to travel down the hallway or into another area.

Decorations that pose a fire hazard and anything hung from the ceiling are prohibited. Draperies and tapestries must be rated flame resistant (NFPA 701). Doorways and all egresses must be kept free and clear at all times. Excessive decorations that are deemed to pose a potential fire hazard (type of material, flammability) are prohibited.

Use of Specific Devices

The use of portable electrical devices, candles, grills, and other devices are governed by the Student Handbook as well as the individual housing agreements, contracts, and leases. Salient points follow:

Extension Cords: The only extension cords allowed are UL listed surge protected, with built-in circuit breakers. Extension cords must never be overloaded, placed across the room threshold, under rugs or anywhere they can be stepped on.

Portable Electrical Appliances: Because of the hazards of fire and the limits on the amount of electricity which can be safely used on any electrical circuit, good judgment should be exercised in using electrical appliances in University housing facilities. Television sets are permitted in residence hall rooms provided all occupants of the room agree. The only appliances allowed in the residence halls are coffee makers, popcorn poppers and hot pots. Open heating devices are not allowed.

Sun lamps, clamp-on-bed lamps, electrical heaters, open-element popcorn poppers, hot plates, indoor grills, hazardous electrical appliances, and appliances in need of electrical repair are specifically prohibited. In addition, the following are not permitted in the apartments – candles, incense, flammable or explosive materials (e.g., fireworks, gunpowder, gasoline, propane), sun lamps, clamp-on bed lamps, electrical heaters, and hot plates.

Fireworks and Explosive Chemicals: No students shall possess, explode, or cause to explode firecrackers or other types of fireworks or explosives in any building or on any property owned or controlled by the University. No students shall, on University property, possess, store, mix, or experiment with any chemical or explosive materials including, but not limited to, gunpowder and gasoline, which may be injurious to the lives and safety of the University community. This regulation shall not apply to instructor supervised learning activities.

Unless acting in compliance with a specific written exemption to this regulation from the Dean of Students and the University Fire Marshall, no students shall use or create an open flame, or use live or glowing embers or charcoal in any University buildings. This regulation shall not apply to instructor supervised learning activities.

Holiday Decorations: Because they are highly combustible, natural Christmas trees and wreaths are prohibited. All holiday lighting must be UL listed and approved. Holiday decorations that are considered excessive or a potential fire safety hazard are prohibited.

Wall Hangings: It is recommended that not more than 10 percent of the available wall space used for wall hangings must be adhered to. Anything that is highly combustible or flammable is prohibited. Decorations that pose a fire hazard and anything hung from the ceiling are prohibited. Draperies and tapestries must be rated flame resistant (NFPA 701). Doorways and all egresses must be kept free and clear at all times. Excessive decorations that are deemed to pose a potential fire hazard (type of material, flammability) are prohibited.

Prohibited Items May Be Confiscated

Items that are prohibited from the residence halls and deemed to be a fire hazard may be confiscated by the Housing and Residence Life or the NMU Police Department staff.

Ceremonial Exemption

Smoking is permitted in compliance with University Regulation. Requests for exception to this regulation for ceremonial or religious purposes may be sought by making a written application to the Dean of Students and the University Fire Marshall.

Fire Safety Education and Training Students

All Summer Orientation Sessions: Housing and Residence Life Meeting – During each (6) Summer Orientation Session (6) students meet with the Director of Housing and residence life. During the orientation session, several fire safety topics are covered, including the causes of fires in residence halls (national), appliances permitted, minimum expectations for power strips, prohibited items, fire safety system equipment in University residence halls and what is expected of students in the event of a fire drill or fire alarm.

After students check into the residence hall, the resident adviser (RA) meets with the students to discuss 1) Highlights from Administrative Policies, including the prohibition against candles and certain appliances; 2) proper use of power strips; and 3) fire safety. In addition, the safety information posted on each residence hall door is reviewed.

Employees

Fire safety and building evacuation procedures are covered during both the professional staff and the paraprofessional staff training. Employees receive an annual e-mail with fire safety and evacuation procedures.

Title of Persons/Organization to Whom Students and Employees Report a Fire

The NMU Police Department (911)

The NMU Police Department non-emergency for fire reporting purposes: (906) 227-2150 or (906) 227-2151

Planned Improvements in Fire Safety

1. Update the apartment lease to state that candles are prohibited;
2. Evaluate the need for additional smoke detectors in the Norwood/Center apartment buildings;
3. Upgrade our aged fire alarm system in the residence halls to our newest fire alarm system which includes the mass notification ability. It also provides a more user friendly interface for our dispatch center.

Completed Improvements in 2019

Northern Michigan University continually assesses our fire alarm systems and fire responses. The following provides upgrades performed in the past year.

The University added smoke detector coverage to our Quad II basement. The area is used by our Housing and Residence Department for storage of miscellaneous furniture items. Smoke detection in this area will provide a quick response should a fire ever occur. The space had been vacant previously.

The Northern Center renovation was also completed this past year. A new fire alarm system was part of that renovation. This system is continuously monitored like the rest of campus.

2017-2019 Fire Log

Name of Facility	2017			2018			2019		
	Fires	Injuries	Deaths	Fires	Injuries	Deaths	Fires	Injuries	Deaths
Center Apartments	1	0	0	0	0	0	0	0	0
1200 Norwood Apartments	0	0	0	0	0	0	0	0	0
1100 Norwood Apartments	0	0	0	0	0	0	0	0	0
Lincoln Apartments	0	0	0	0	0	0	0	0	0
Magers Hall	0	0	0	0	0	0	0	0	0
Spooner Hall	0	0	0	0	0	0	0	0	0
West Hall	0	0	0	0	0	0	0	0	0
Spalding Hall	0	0	0	0	0	0	0	0	0
Halverson Hall	0	0	0	0	0	0	0	0	0
Meyland Hall	0	0	0	0	0	0	0	0	0
Hunt Hall	0	0	0	0	0	0	0	0	0
Van Antwerp Hall	0	0	0	0	0	0	0	0	0
Woodland Apartments	0	0	0	0	0	0	0	0	0
Maple East	0	0	0	0	0	0	0	0	0
Maple West	0	0	0	0	0	0	0	0	0
Cedar East	0	0	0	0	0	0	0	0	0
Cedar West	0	0	0	0	0	0	0	0	0
Birch East	0	0	0	0	0	0	0	0	0
Birch West	0	0	0	0	0	0	0	0	0
The Woods-Lodge	0	0	0	0	0	0	0	0	0
Total	1	0	0	0	0	0	0	0	0

Please see the Northern Michigan University Police Department [Clery page](#) for a list of current Campus Security Authorities on campus.

Alcohol and Other Drugs Information Guide

This document complies with the **Drug-Free Schools and Communities Act Amendments of 1989**. Northern Michigan University has adopted and implemented a program to prevent the unlawful possession, use or distribution of illicit drugs and alcohol by students and employees.

The program includes annual distribution in writing to each employee and to each enrolled student of:

- Standards of conduct for students and employees
- A description of associated and legal sanctions
- A description of associated health risks
- A description of available services and treatment options

Alcohol and other drug issues have received much attention nationally and locally. Many students, faculty and staff have worked together over the years to prevent substance abuse at Northern Michigan University. We think our efforts have contributed to a healthy living-learning community and have assisted individuals in need.

Northern Michigan University is committed to preventing substance abuse by:

- Encouraging a campus environment where healthful lifestyle choices are made by students, faculty and staff.
- Expecting acceptance of responsibility for one's own choices and behavior.
- Striving to balance the rights of individuals and those of the university community.
- Encouraging chemical-free activities and supporting those who choose not to use alcohol and other drugs.
- Enforcing university, local and state codes, ordinances and statutes, which govern alcohol and other drug use.

Students of Northern Michigan University
<p>The Northern Michigan University Student Handbook (http://www.nmu.edu/handbook) prohibits the use, possession, sale or consumption of alcoholic beverages by students in any building or on any property owned or controlled by NMU (except under terms and conditions established by the president or designee) and states that no student shall illegally possess, use or have under his/her control any other controlled substance in any building or on property owned or controlled by the University.</p> <p>Failure to abide by these regulations may lead to any of the following sanctions: (1) warning, (2) warning probation, (3) disciplinary probation, (4) suspension or (5) expulsion. Special conditions may be attached to the penalty including, but not limited to, parental notification of the violation and mandatory participation in an alcohol or other drug education program.</p>

Employees of Northern Michigan University

Northern Michigan University prohibits the unlawful manufacture, distribution, dispensing, possession or use of any controlled substance or alcohol by employees of university-owned, used or controlled premises, except when possessed or used within the scope of the employee's assigned duties and as authorized by law.

Any employee violating this policy will be subject to the following disciplinary actions up to and including discharge: (1) verbal warning, (2) written reprimand, (3) suspension without pay, (4) discharge. Disciplinary action may differ from one another depending on the terms set forth in the union contracts.

Furthermore, any employee providing alcohol to an underage student or controlled substance to a student, regardless of the setting, may be subject to the above disciplinary actions.

Health Risks Associated with Alcohol and Other Drug Use

Regular use of alcohol and other drugs (including marijuana, stimulants, depressants, cocaine, anabolic steroids, opiates, hallucinogens) may lead to:

- psychological and/or physical dependence
- impaired learning ability, memory, ability to solve complex problems
- inability to perform sexually, infertility problems
- increased risk of sexually transmitted diseases (including AIDS)
- complications due to the combination of prescription medication and other drugs/alcohol
- death, coma or toxic reactions, especially when combining alcohol with any other drug, including over-the-counter medicine or prescriptions
- guilt/regret over activities performed while under the influence of alcohol/drugs, i.e., regretting sexual encounters, fighting, risk-taking, legal difficulties
- organic damage to brain, cardiovascular system, liver, etc.
- increased risk of cancer
- fetal Alcohol Syndrome, birth or genetic defects
- psychosis (hallucinations, loss of contact with reality, extreme changes in personality)
- other physiological, psychological or interpersonal problems

Substance Abuse Resources

On Campus	
Health Promotion Office (1201 University Center)	906-227-1455
Employee Assistance Service	906-227-2330
Counseling and Consultation Services (3405 Hedgcock)	906-227-2981

Marquette Area	
Alcoholic Treatment Center (24-hour helpline)	800-260-4014
Alcoholics and Narcotics (24-hour helpline)	906-228-2611
Alcoholics Anonymous	906-249-4430
Aspen Breeze Treatment Center	906-226-2527
Bell Behavioral Services	906-249-9002
Drug Abuse Treatment Center (24-hour helpline)	800-259-7115
Great Lakes Recovery Centers	906-228-7611
Outpatient services	906-228-6545
Youth residential	906-228-4692

APPENDIX:

Campus Security Authority Policy

Clery Act

Student Handbook Policies: Includes Alcoholic Beverages - Possession or Use of
Building Security; Drugs: Possession, Use or Sale; Fire Safety; Weapons

Alcohol and Drug Information Guide – Drug Free School Medical Amnesty Policy

Campus Emergency Policy

Fire Alarm Evacuation Policy

Emergency Response Guidelines Policy

Relationship Violence, Sexual Misconduct, and Stalking Policy

Missing Person Policy

NMU Ordinances: Includes Dangerous Materials; Fire Building Evacuation; Fireworks,
Weapons and Explosives.

Drug-Free Schools Biennial Review